



28th Annual Regional Local Roads Conference

Asphalt Milling Embedment for Road Stabilization

County Road 'K'

Scotts Bluff County, Nebraska

Robert Bennett – County Highway Superintendent

Presented By

Don Neary

Nebraska LTAP

University of Nebraska – Lincoln

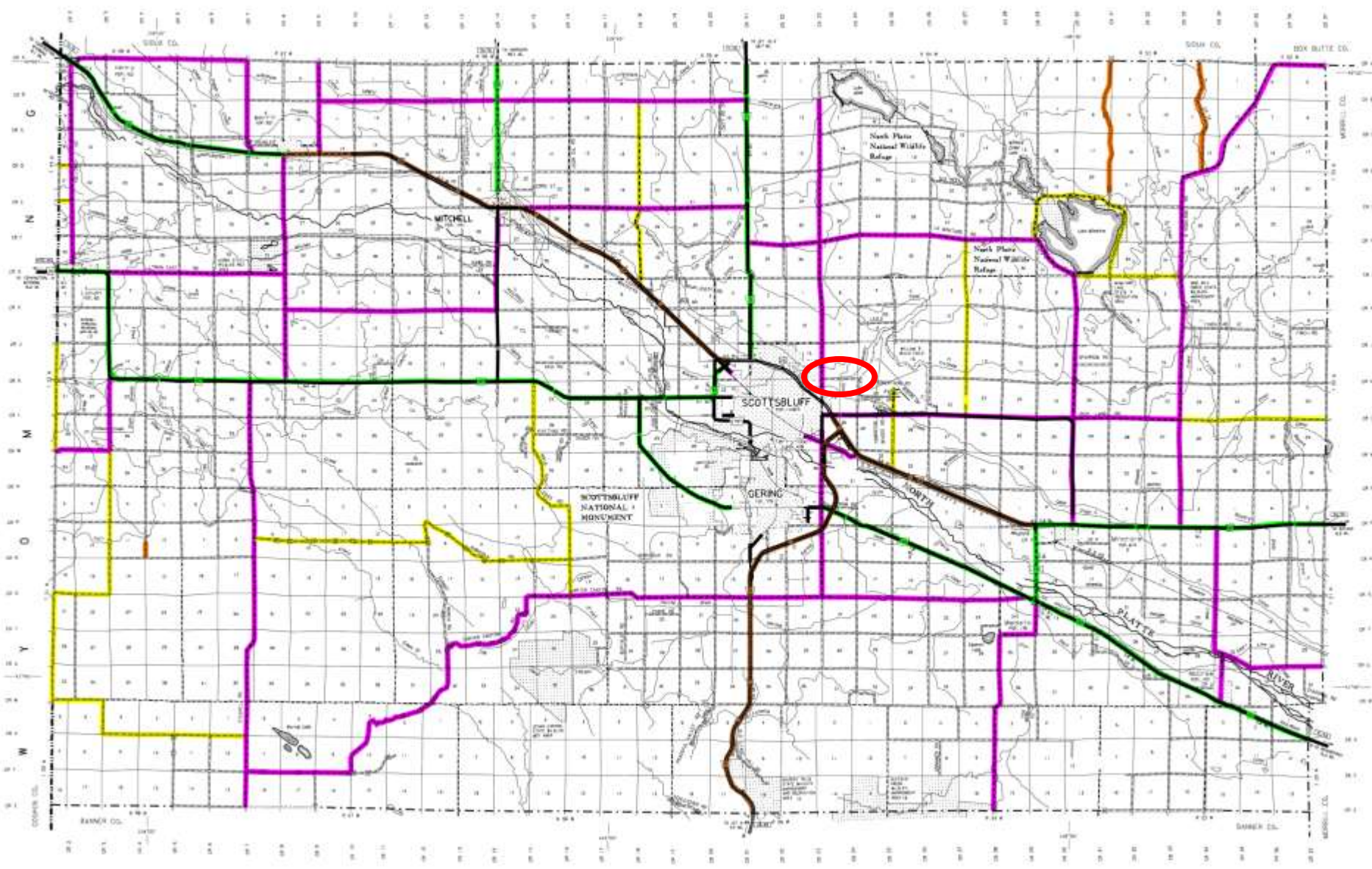

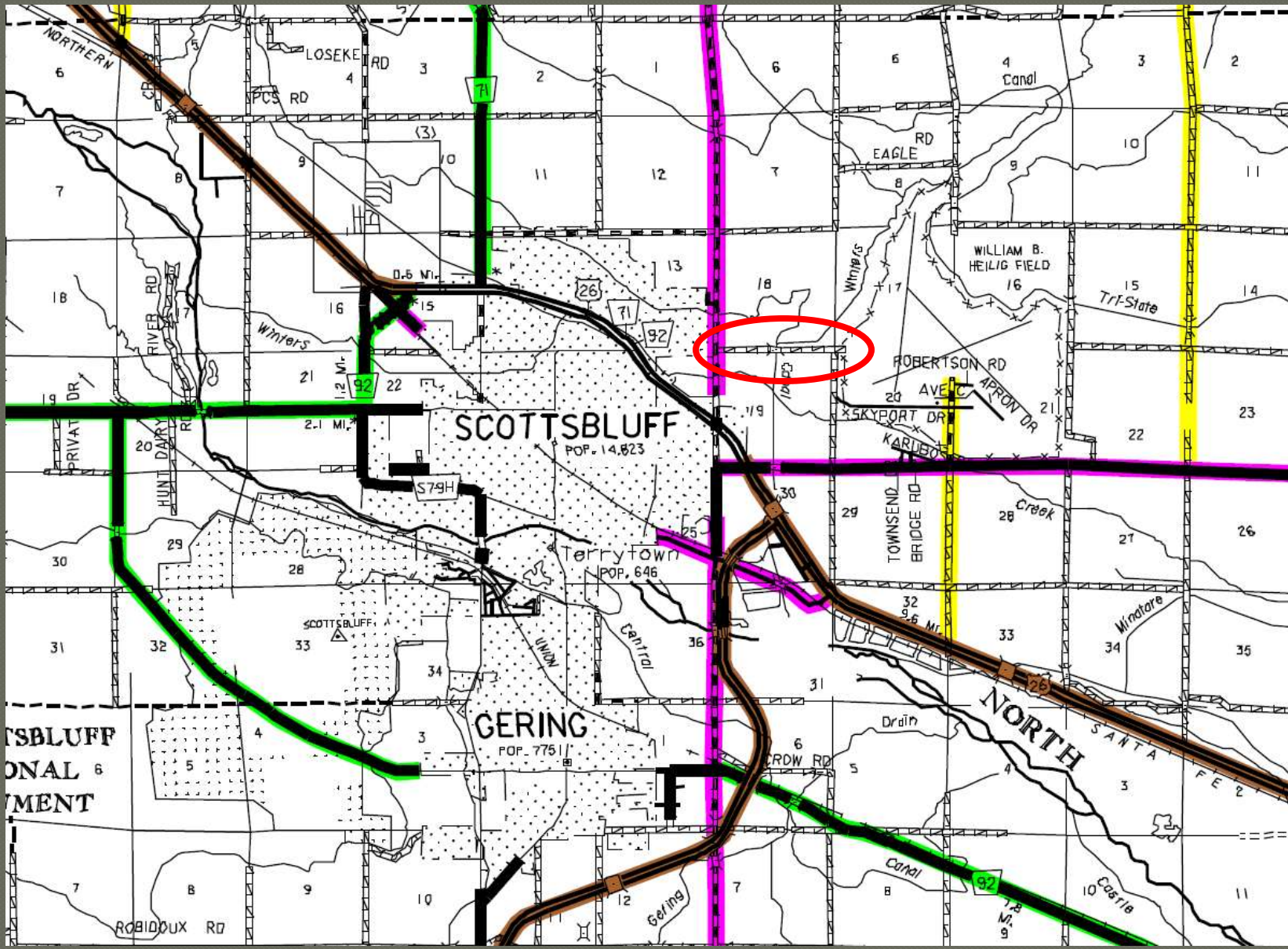

Asphalt Millings



Asphalt Millings



Scarifying



Watering



Cutting & Mixing



Windrow Mixing



Windrow Mixing



Windrow Mixing



Windrow Mixing



Pulling Lifts & Compacting



Pulling Lifts & Compacting



Proper Road Profile



Nearing Completion



A Good Mix, No Segregation



Maintaining the Crown



Final Product



3 Months



3 Months



4 Months



Equipment & Personnel

◉ Day 1

- 6 Trucks & Drivers
- 1 Vibratory Sheepsfoot & Operator
- 1 Motor Grader & Operator

◉ Day 2

- 2 Motor Graders & Operators
- Water Truck & Driver

◉ Day 3

- 1 Motor Grader & Operator
- 1 Pneumatic Roller & Operator
- 1 Water Truck & Driver

Project Costs

- ◎ Asphalt Millings – Traded Paint Striping
 - Estimated under \$2000
- ◎ Personnel Hours – 113 Hours
 - \$3500
- ◎ Equipment Cost
 - \$3300
- ◎ Total Cost - \$8800



28th Annual Regional Local Roads Conference

Asphalt Milling Embedment
for Road Stabilization

QUESTIONS?